

This introduction is for the guidance in the process of installation. Please carefully read the introduction before using, and give the correct maintenance to the furniture.

Cleaning Notes:

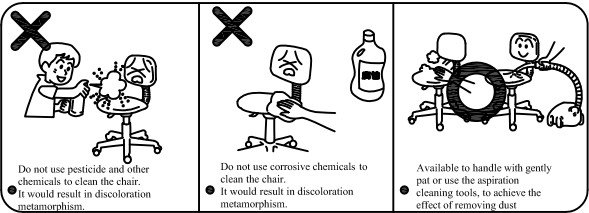

Cautions

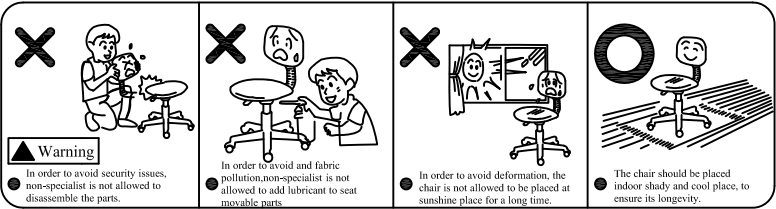

Safety Precautions

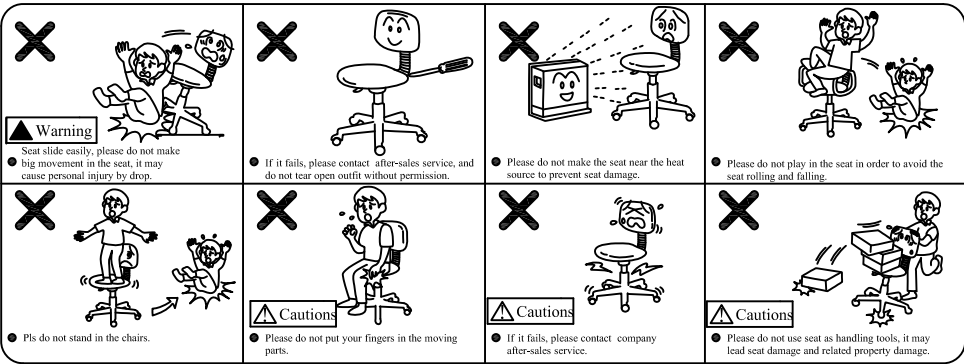

Introduction for installation

- Make sure of the location for the furniture before installation to avoid the big move after the furniture installation completed.
- Don't put furniture in moist or muggy environment
- Please check the product packaging bag and fittings according to the packing list , and figure out the components structure according to the installation introduction.
- Please make sure for the direction of each parts when unpacking before installation.
- Please be meticulous and patient for fine adjustment during the furniture installation.
- Please make a gentle shake to test the screw tight or not and the furniture stability after installation.
- Please open the door and drawer for a period to Ventilate before using to eliminate odor.



Thank you very much to choose our service, and pls carefully read this instruction before using.

Product Introduction

Item: CMG10GS CMG11GS
Name: Office Chair
Size: 565W*535D*820H, SH: 445mm
Material: High-quality Wood, Electroplated Chrome Alloy/Steel
Cube/Painted Wood, High-density Moulded Foam/Cutted Foam.
Standard: QB/T2280-2016 Office furniture Office chair

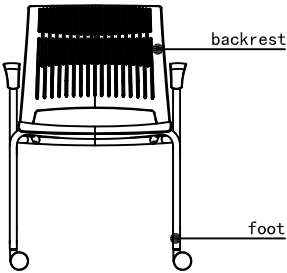

This product is suitable for office use only, and the decorative accessories is for indoor use only.
If you change your product into new ones, please leave the old one to professional and qualified recycle companies.

Zhejiang Sunon Furniture Manufacture Co., Ltd
Customer Service Hotline: 4008-600-666
Website: www.sunon-china.com
Headquarters Address: Sunon Central Buisness Building, No. 200 Citizen Street, Qianjiang CBD, Hangzhou, Zhejiang
Manufacturing Base Address: 35th, Ningdong Road, Xiaoshan Economic and Technological Development Zone, Hangzhou, Zhejiang
Manufacturing Base Address: 6th Anren Road, Jianshan Haining Economic Development Zone, Zhejiang

Materials

Surface	Leather	High quality leather with good glossiness,comfortable permeability and full of toughness.
	PU/Artificial	Optional colors in good quality
	Fabric	High quality fabric, flame retardant and antifouling
Filler	High density Foam	Comfortable, elastic
Fittings	Plywood board	High quality poplar
	Mechanism	Pass American ANSI/BIFMA X5.1-2017 Test.
	Gas lift	Pass American ANSI/BIFMA X5.1-2017 Test.
	Five star feet	
	Castor	
	Arm-rest	

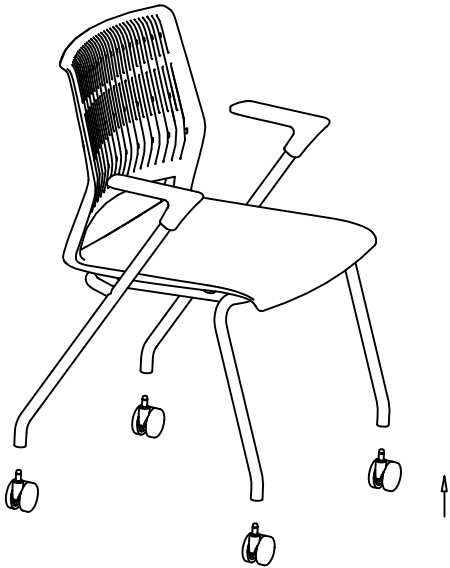

Fittings

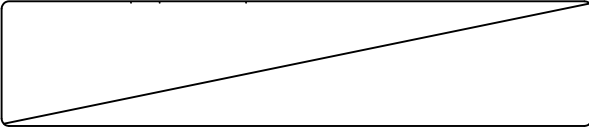

Function

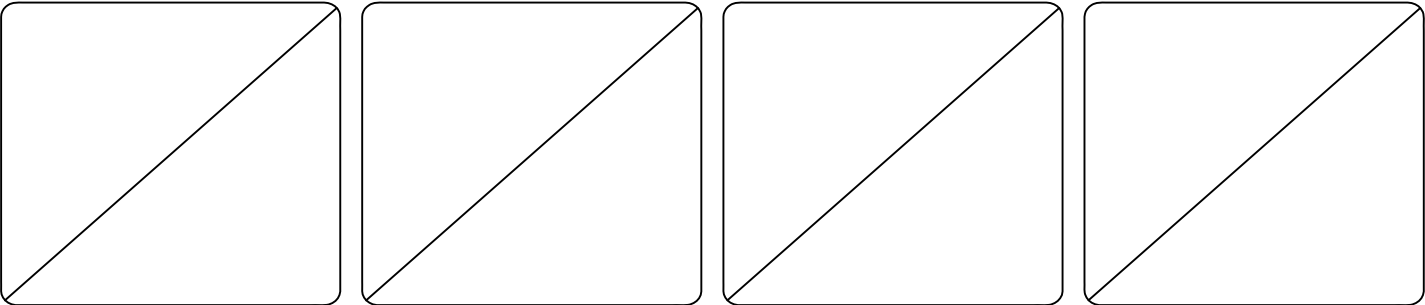

- 1. This configuration does not involve adjusting function.
- 2. Please use according to the normal standards.

This introduction is for the guidance in the process of installation. Please carefully read the introduction before using, and give the correct maintenance to the furniture.

Cleaning Notes:

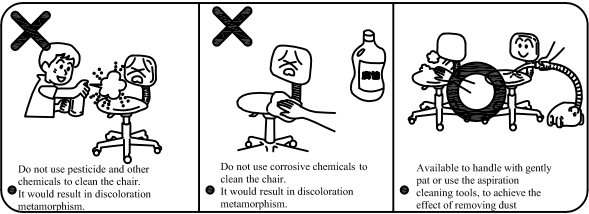

Cautions

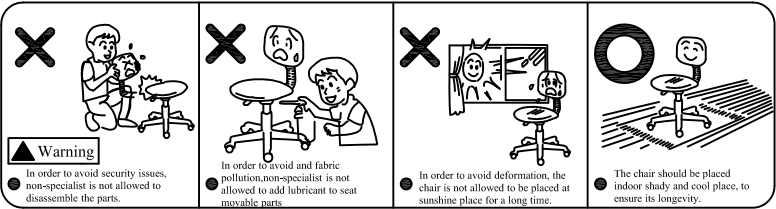

Safety Precautions

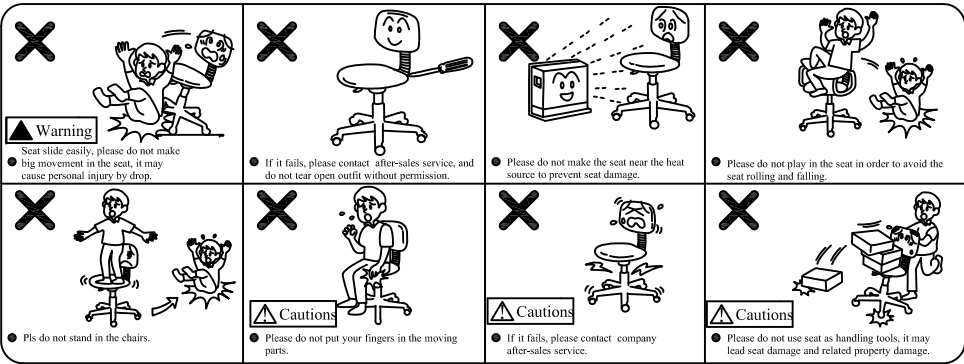

Introduction for installation

- Make sure of the location for the furniture before installation to avoid the big move after the furniture installation completed.
- Don't put furniture in moist or muggy environment
- Please check the product packaging bag and fittings according to the packing list , and figure out the components structure according to the installation introduction.
- Please make sure for the direction of each parts when unpacking before installation.
- Please be meticulous and patient for fine adjustment during the furniture installation.
- Please make a gentle shake to test the screw tight or not and the furniture stability after installation.
- Please open the door and drawer for a period to Ventilate before using to eliminate odor.



Thank you very much to choose our service, and pls carefully read this instruction before using.

Product Introduction

Item: CMG12GS CMG13GS
Name: Office Chair
Size: 525W*525D*820H. Seat height: 420mm
Material: High-quality Wood, Electroplated Chrome Alloy/Steel
Cube/Painted Wood, High-density Moulded Foam/Cutted Foam.
Standard: QB/T2280-2016 Office furniture Office chair

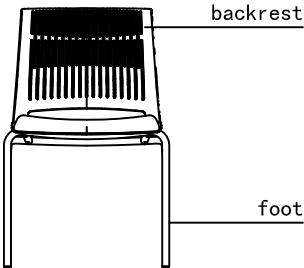

This product is suitable for office use only, and the decorative accessories is for indoor use only.
If you change your product into new ones, please leave the old one to professional and qualified recycle companies.

Zhejiang Sunon Furniture Manufacture Co., Ltd
Customer Service Hotline: 4008-600-666
Website: www.sunon-china.com
Headquarters Address: Sunon Central Buisness Building, No. 200 Citizen Street, Qianjiang CBD, Hangzhou, Zhejiang
Manufacturing Base Address: 35th, Ningdong Road, Xiaoshan Economic and Technological Development Zone, Hangzhou, Zhejiang
Manufacturing Base Address: 6th Anren Road, Jianshan Haining Economic Development Zone, Zhejiang

Materials

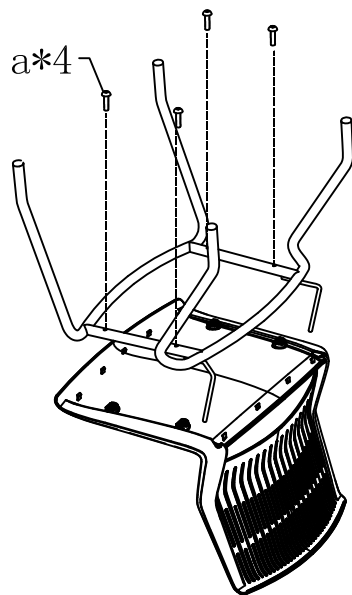

Surface	Leather	High quality leather with good glossiness, comfortable permeability and full of toughness.
	PU/Artificial	Optional colors in good quality
	Fabric	High quality fabric, flame retardant and antifouling
Filler	High density Foam	Comfortable, elastic
Fittings	Plywood board	High quality poplar
	Mechanism	Pass American ANSI/BIFMA X5.1-2017 test
	Gas lift	Pass American ANSI/BIFMA X5.1-2017 Test.
	Five star feet	
	Castor	
	Arm-rest	

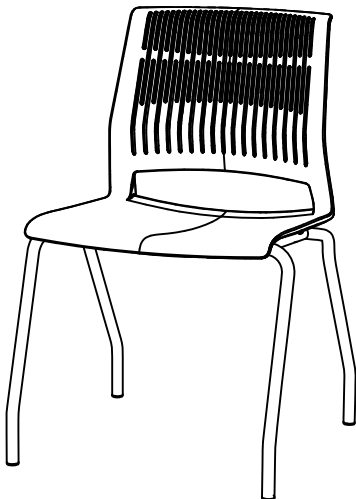

step1



Fittings

<p>a</p>  <p>Screw M6*22 4pcs</p>	<p>b</p>  <p>Wrench 5# 1PCS</p>	
--	--	--

Product function

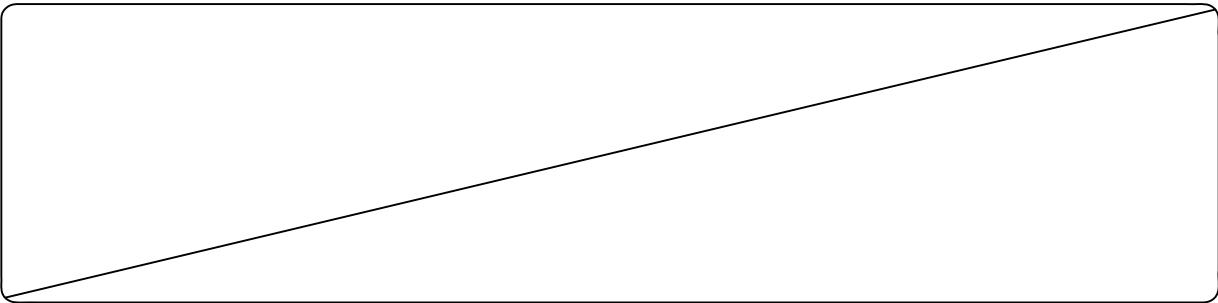

- 1、 This configuration does not involve adjusting function.
- 2、 Please use according to the normal standards.

This introduction is for the guidance in the process of installation. Please carefully read the introduction before using, and give the correct maintenance to the furniture.

Cleaning Notes:

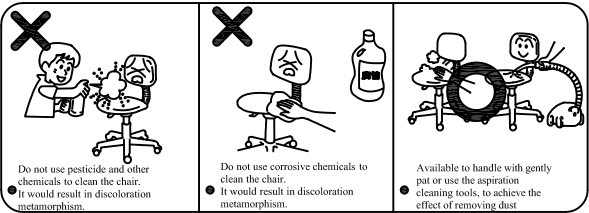

Cautions

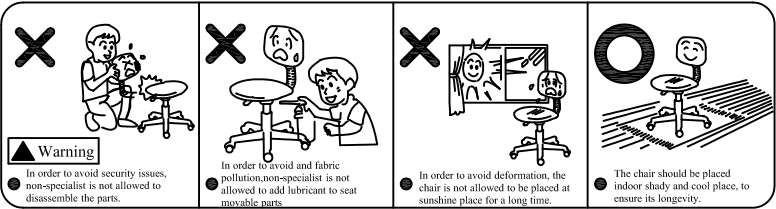

Safety Precautions

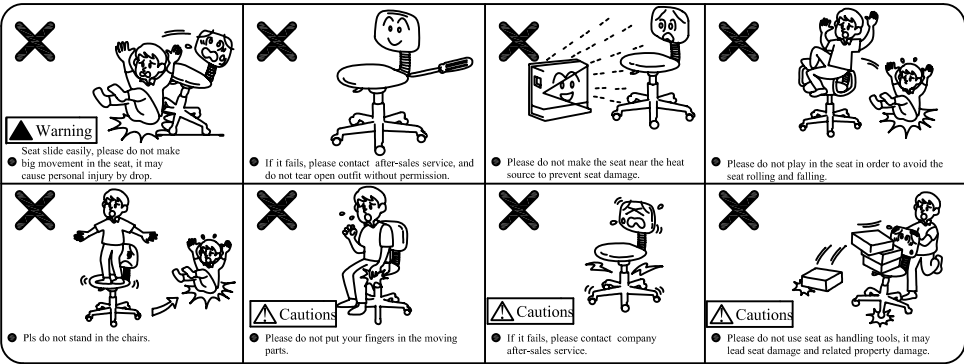

Introduction for installation

- Make sure of the location for the furniture before installation to avoid the big move after the furniture installation completed.
- Don't put furniture in moist or muggy environment
- Please check the product packaging bag and fittings according to the packing list , and figure out the components structure according to the installation introduction.
- Please make sure for the direction of each parts when unpacking before installation.
- Please be meticulous and patient for fine adjustment during the furniture installation.
- Please make a gentle shake to test the screw tight or not and the furniture stability after installation.
- Please open the door and drawer for a period to Ventilate before using to eliminate odor.



Thank you very much to choose our service, and pls carefully read this instruction before using.

Product Introduction

Item: CMG14GS CMG15GS
Name: Office Chair
Size: 570W*520D*815H. Seat height: 415mm
Material: High-quality Wood, Electroplated Chrome Alloy/Steel Cube/Painted Wood, High-density Moulded Foam/Cutted Foam.
Standard: QB/T2280-2016 Office furniture Office chair
HJ 2547-2016 Technical Requirement for Environmental Labeling Products Furniture

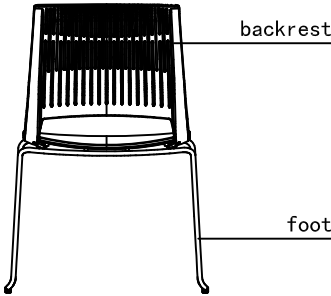

This product is suitable for office use only, and the decorative accessories is for indoor use only.
If you change your product into new ones, please leave the old one to professional and qualified recycle companies.

Zhejiang Sunon Furniture Manufacture Co., Ltd
Customer Service Hotline: 4008-600-666
Website: www.sunon-china.com
Headquarters Address: Sunon Central Buisness Building, No. 200 Citizen Street, Qianjiang CBD, Hangzhou, Zhejiang
Manufacturing Base Address: 35th, Ningdong Road, Xiaoshan Economic and Technological Development Zone, Hangzhou, Zhejiang
Manufacturing Base Address: 6th Anren Road, Jianshan Haining Economic Development Zone, Zhejiang

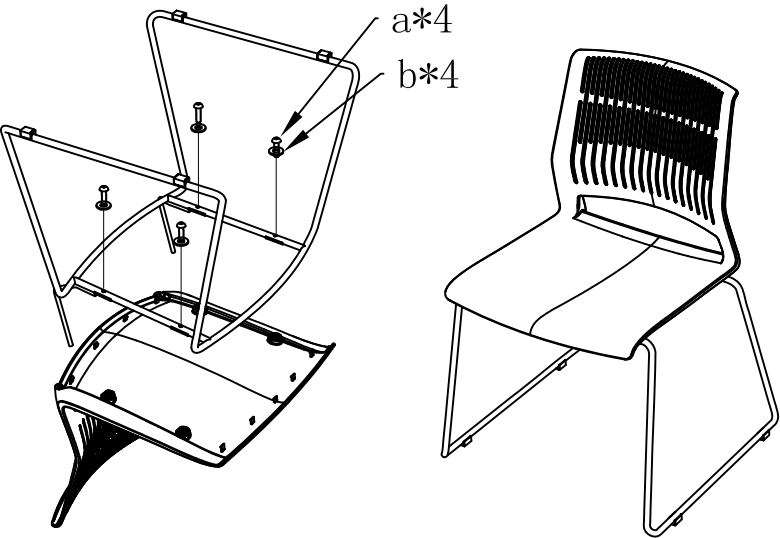

Materials

Surface	Leather	High quality leather with good glossiness,comfortable permeability and full of toughness.
	PU/Artificial	Optional colors in good quality
	Fabric	High quality fabric, flame retardant and antifouling
Filler	High density Foam	Comfortable, elastic
Fittings	Plywood board	High quality poplar
	Mechanism	Pass American ANSI/BIFMA X5.1 test
	Gas lift	Pass American ANSI/BIFMA X5.1 Test.
	Five star feet	
	Castor	
	Arm-rest	



step1

Fittings

a	b	c	
			
screw M6*20 4pcs	Washer Ø6 4PCS	spanner 4# 1pcs	

Product function

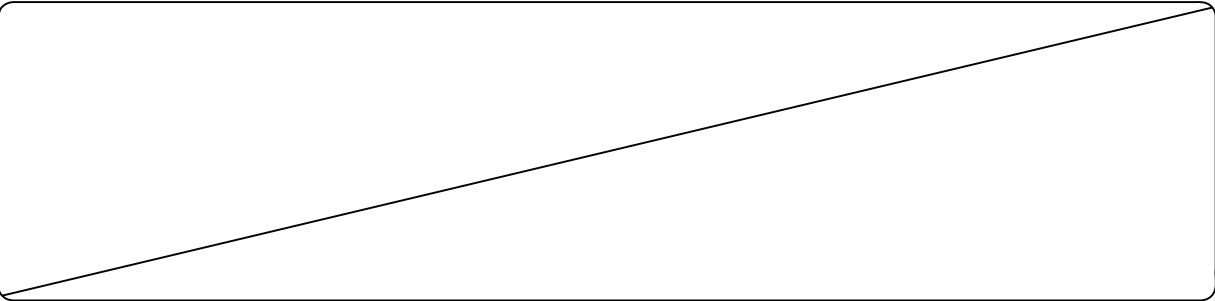

- 1、 This configuration does not involve adjusting function.
- 2、 Please use according to the normal standards.

This introduction is for the guidance in the process of installation. Please carefully read the introduction before using, and give the correct maintenance to the furniture.

Cleaning Notes:

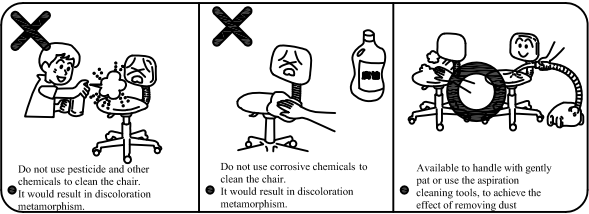

Cautions

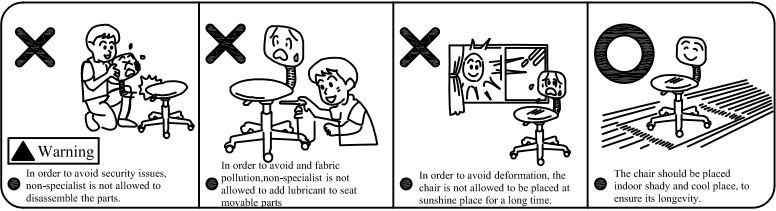

Safety Precautions

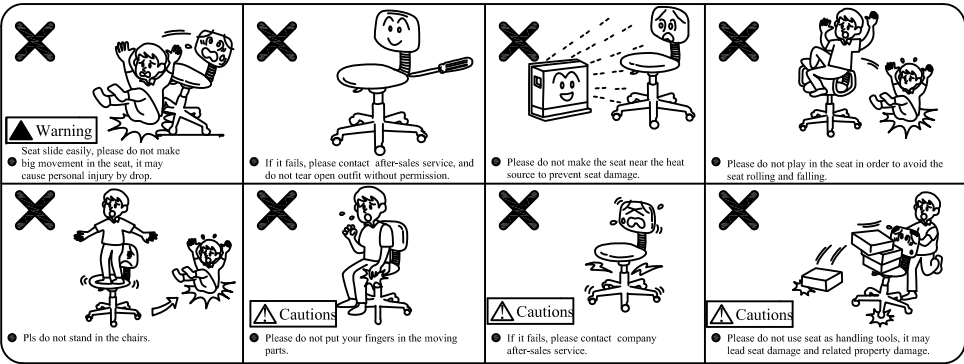

Introduction for installation

- Make sure of the location for the furniture before installation to avoid the big move after the furniture installation completed.
- Don't put furniture in moist or muggy environment
- Please check the product packaging bag and fittings according to the packing list , and figure out the components structure according to the installation introduction.
- Please make sure for the direction of each parts when unpacking before installation.
- Please be meticulous and patient for fine adjustment during the furniture installation.
- Please make a gentle shake to test the screw tight or not and the furniture stability after installation.
- Please open the door and drawer for a period to Ventilate before using to eliminate odor.



Thank you very much to choose our service, and pls carefully read this instruction before using.

Product Introduction

Item: CMG16GS
Name: Office Chair
Size: 475W*475D*790H, SH:710mm
Material: High-quality Wood, Electroplated Chrome Alloy/Steel
Cube/Painted Wood, High-density Moulded Foam/Cutted Foam.
Standard: QB/T2280-2016 Office furniture Office chair

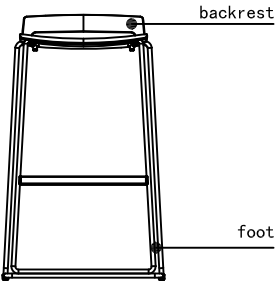

This product is suitable for office use only, and the decorative accessories is for indoor use only.
If you change your product into new ones, please leave the old one to professional and qualified recycle companies.

Zhejiang Sunon Furniture Manufacture Co., Ltd



Customer Service Hotline: 4008-600-666
Website: www.sunon-china.com
Headquarters Address: Sunon Central Buisness Building, No. 200 Citizen Street, Qianjiang CBD, Hangzhou, Zhejiang
Manufacturing Base Address: 35th, Ningdong Road, Xiaoshan Economic and Technological Development Zone, Hangzhou, Zhejiang
Manufacturing Base Address: 6th Anren Road, Jianshan Haining Economic Development Zone, Zhejiang

Materials

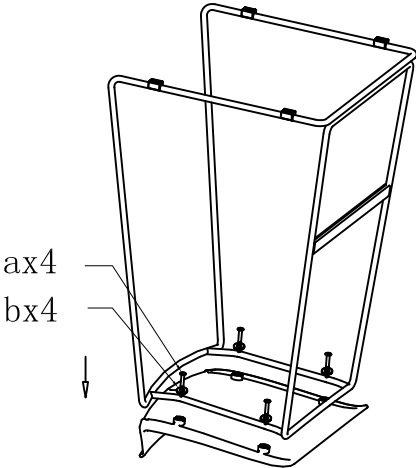
Surface	Leather	High quality leather with good glossiness,comfortable permeability and full of toughness.
	PU/Artificial	Optional colors in good quality
	Fabric	High quality fabric, flame retardant and antifouling
Filler	High density Foam	Comfortable, elastic
Fittings	Plywood board	High quality poplar
	Mechanism	Pass American ANSI/BIFMA X5.1-2017 Test.
	Gas lift	Pass American ANSI/BIFMA X5.1-2017 Test.
	Five star feet	
	Castor	
	Arm-rest	

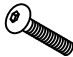

Fittings

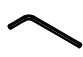
a	b	c	
			
screw M6x20 4PCS	washer Φ6 4PCS	spanner 4mm 1PCS	

Function

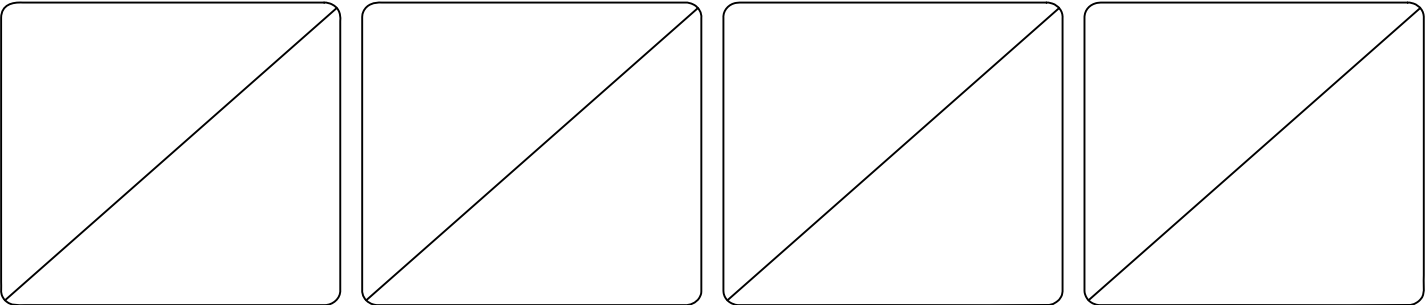

1. This configuration does not involve adjusting function.
2. Please use according to the normal standards.

This introduction is for the guidance in the process of installation. Please carefully read the introduction before using, and give the correct maintenance to the furniture.

Cleaning Notes:

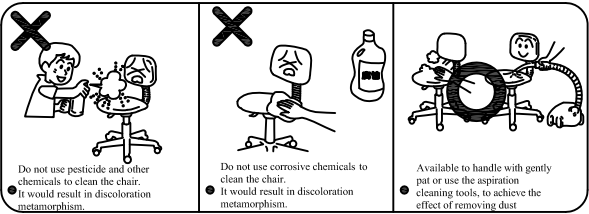

Cautions

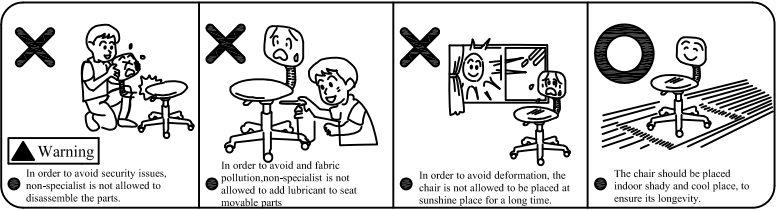

Safety Precautions

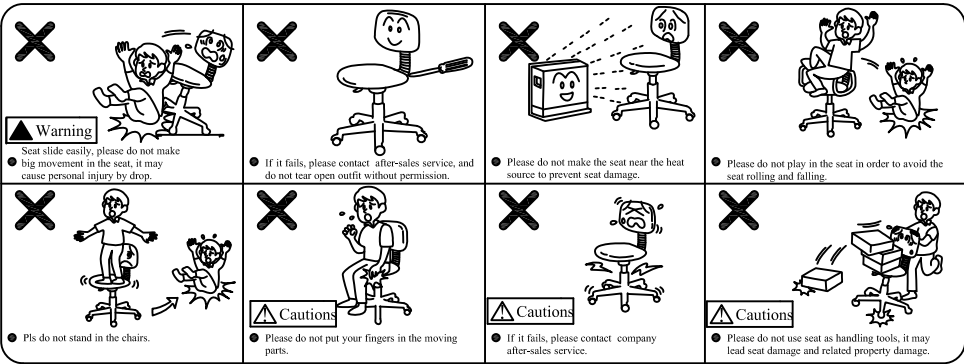

Introduction for installation

- Make sure of the location for the furniture before installation to avoid the big move after the furniture installation completed.
- Don't put furniture in moist or muggy environment
- Please check the product packaging bag and fittings according to the packing list , and figure out the components structure according to the installation introduction.
- Please make sure for the direction of each parts when unpacking before installation.
- Please be meticulous and patient for fine adjustment during the furniture installation.
- Please make a gentle shake to test the screw tight or not and the furniture stability after installation.
- Please open the door and drawer for a period to Ventilate before using to eliminate odor.



Thank you very much to choose our service, and pls carefully read this instruction before using.

Product Introduction

Item: CMG60BS CMG61BS
Name: Office Chair
Size: 475W*520D*795H/475W*525D*780H, SH:400/390mm
Material: High-quality Wood, Electroplated Chrome Alloy/Steel
Cube/Painted Wood, High-density Moulded Foam/Cutted Foam.
Standard: QB/T2280-2016 Office furniture Office chair

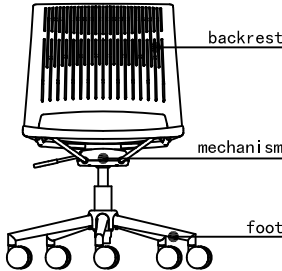

This product is suitable for office use only, and the decorative accessories is for indoor use only.
If you change your product into new ones, please leave the old one to professional and qualified recycle companies.

Zhejiang Sunon Furniture Manufacture Co., Ltd
Customer Service Hotline: 4008-600-666
Website: www.sunon-china.com
Headquarters Address: Sunon Central Buisness Building, No. 200 Citizen Street, Qianjiang CBD, Hangzhou, Zhejiang
Manufacturing Base Address: 35th, Ningdong Road, Xiaoshan Economic and Technological Development Zone, Hangzhou, Zhejiang
Manufacturing Base Address: 6th Anren Road, Jianshan Haining Economic Development Zone, Zhejiang

Materials

Surface	Leather	High quality leather with good glossiness,comfortable permeability and full of toughness.
	PU/Artificial	Optional colors in good quality
	Fabric	High quality fabric, flame retardant and antifouling
Filler	High density Foam	Comfortable, elastic
Fittings	Plywood board	High quality poplar
	Mechanism	Pass American ANSI/BIFMA X5.1-2017 Test.
	Gas lift	Pass American ANSI/BIFMA X5.1-2017 Test.
	Five star feet	
	Castor	
	Arm-rest	

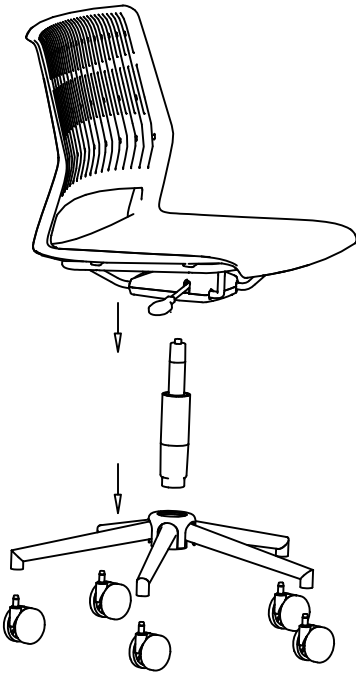

Fittings

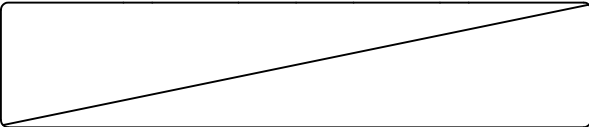

Function

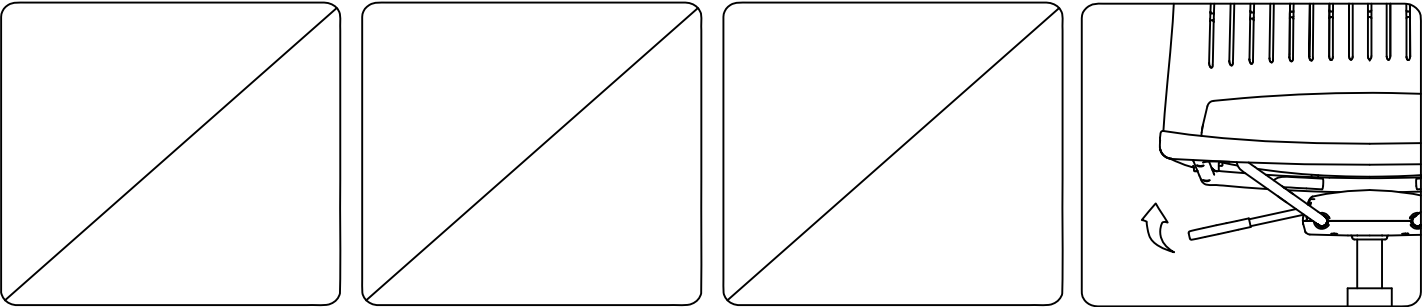

1、Adjustable seat height:
Pull or push the control lever to adjust the seat to a comfortable height ;

This introduction is for the guidance in the process of installation. Please carefully read the introduction before using, and give the correct maintenance to the furniture.

Cleaning Notes:

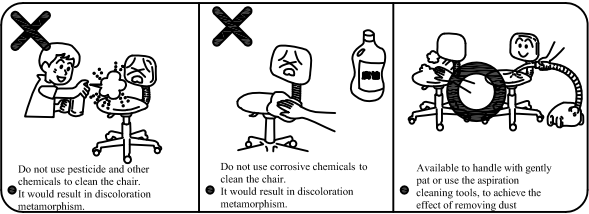

Cautions

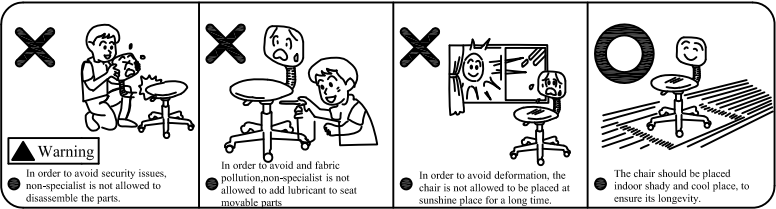

Safety Precautions

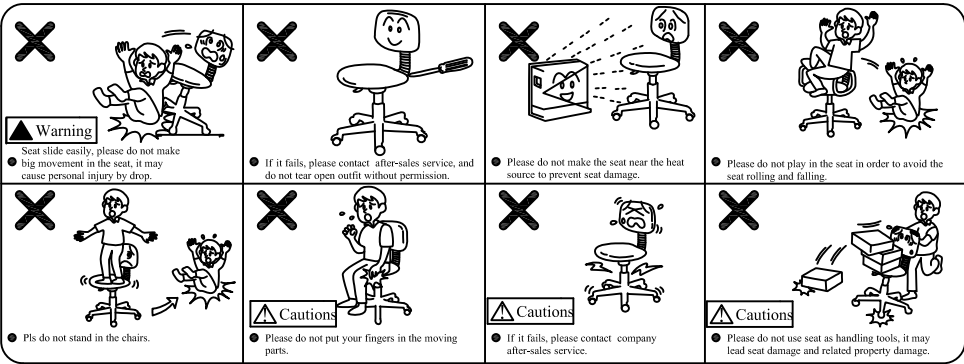

Introduction for installation

- Make sure of the location for the furniture before installation to avoid the big move after the furniture installation completed.
- Don't put furniture in moist or muggy environment
- Please check the product packaging bag and fittings according to the packing list , and figure out the components structure according to the installation introduction.
- Please make sure for the direction of each parts when unpacking before installation.
- Please be meticulous and patient for fine adjustment during the furniture installation.
- Please make a gentle shake to test the screw tight or not and the furniture stability after installation.
- Please open the door and drawer for a period to Ventilate before using to eliminate odor.



Thank you very much to choose our service, and pls carefully read this instruction before using.

Product Introduction

Item: CMG62BS
Name: Office Chair
Size: 475W*545D*970H, SH:515mm
Material: High-quality Wood, Electroplated Chrome Alloy/Steel
Cube/Painted Wood, High-density Moulded Foam/Cutted Foam.
Standard: QB/T2280-2016 Office furniture office chair

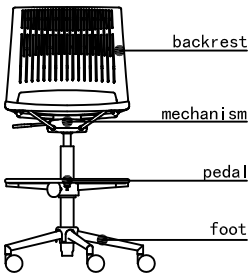

This product is suitable for office use only, and the decorative accessories is for indoor use only.
If you change your product into new ones, please leave the old one to professional and qualified recycle companies.

Zhejiang Sunon Furniture Manufacture Co., Ltd

Customer Service Hotline: 4008-600-666
Website: www.sunon-china.com
Headquarters Address: Sunon Central Buisness Building, No. 200 Citizen Street, Qianjiang CBD, Hangzhou, Zhejiang
Manufacturing Base Address: 35th, Ningdong Road, Xiaoshan Economic and Technological Development Zone, Hangzhou, Zhejiang
Manufacturing Base Address: 6th Anren Road, Jianshan Haining Economic Development Zone, Zhejiang

Materials

Surface	Leather	High quality leather with good glossiness,comfortable permeability and full of toughness.
	PU/Artificial	Optional colors in good quality
	Fabric	High quality fabric, flame retardant and antifouling
Filler	High density Foam	Comfortable, elastic
Fittings	Plywood board	High quality poplar
	Mechanism	Pass American ANSI/BIFMA X5.1-2017 Test.
	Gas lift	Pass American ANSI/BIFMA X5.1-2017 Test.
	Five star feet	
	Castor	
	Arm-rest	

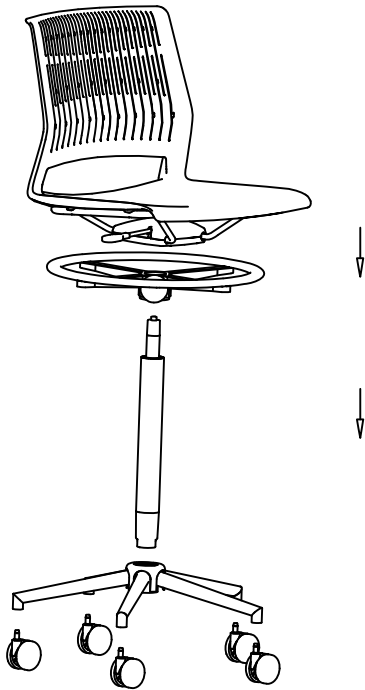

Fittings

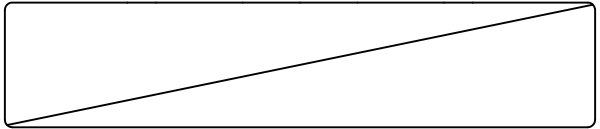

Function

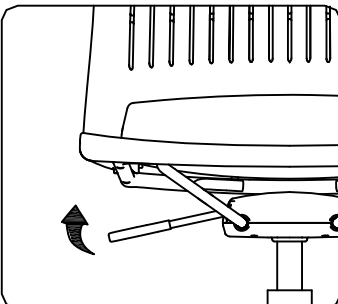
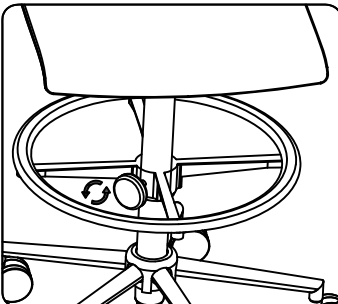
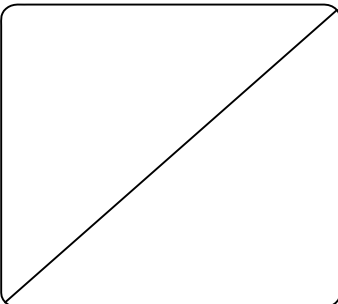
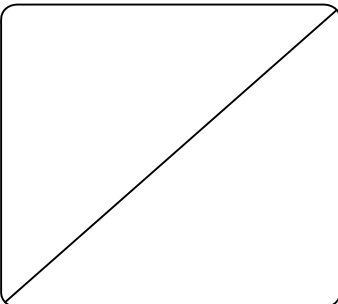

1. Adjustment of Footrest
Fix footrest: Rotate the knob clockwise to fix the footrest to an appropriate position.
Free footrest: Rotate the knob anticlockwise to adjust the footrest freely.
2. Adjustment of Seat Height
Upward: Get up and pull the controlling handle to lift the seat to the appropriate height.
Downward: Press down and pull the controlling handle to lower the seat to the appropriate height.



MAGNA Series Installation Manual

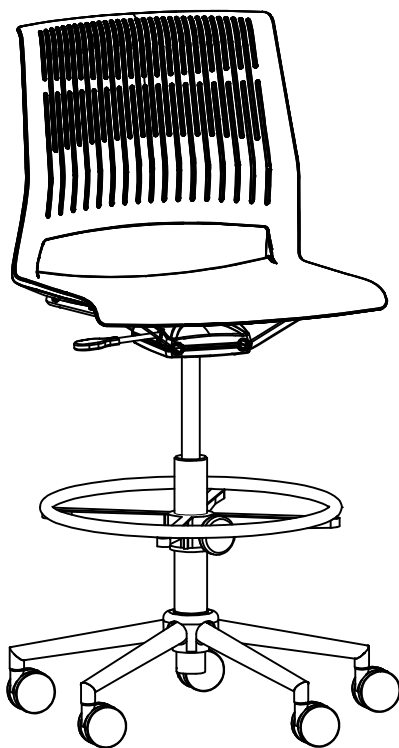

This manual is used for the installation of MG.CMG62BS
Please read this manual carefully before use and keep it properly.

Assembly note:

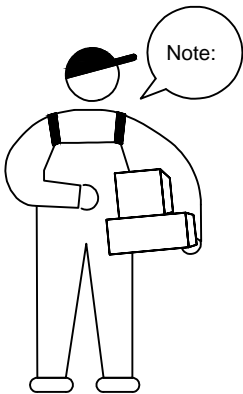

● Use a protective mat and handle the product with care.

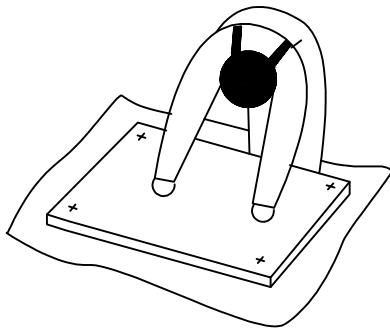

● At least two people are required.

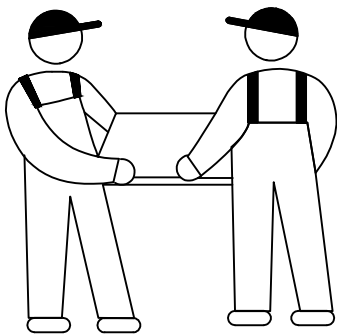

● Contact Sunon if you have any confusions.

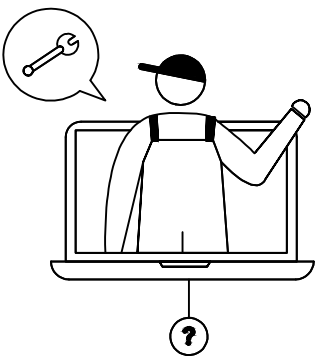

This picture shows all the accessories required, among which some are key accessories.
If you have missed any, please contact Sunon at 949-337-8838

Exploded diagram:

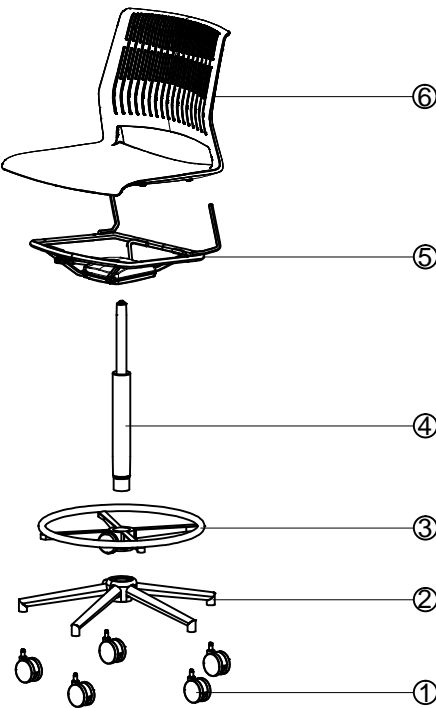

No.	Name	Pcs
1	caster	5
2	star base	1
3	foot rest	1
4	gas lift	1
5	mechanism	1
6	backrest	1

1. Place the star base upside down and insert the 5 casters into the holes at the end of each leg of the star base.

1

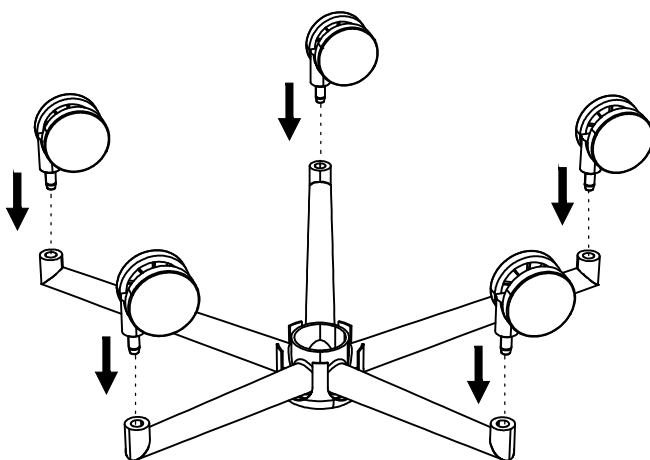

2. Turn the star base over insert the foot rest from the bottom of the gas lift; insert gas lift with foot rest through the center hole on top of the star base. Then turn the adjustment knob C clockwise to tighten the foot rest.

2

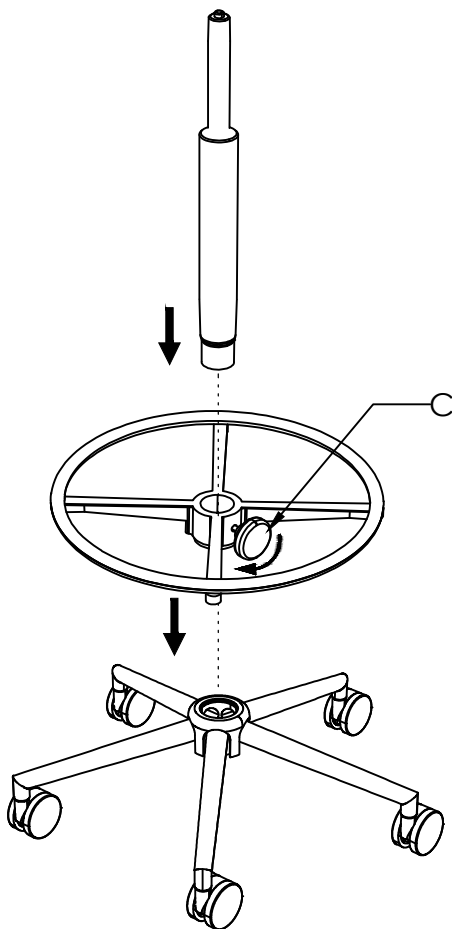

-
3. Align the mechanism hole with the upper end of the gas lift and lay down the chair vertically. The installation of chair is done.
-

3

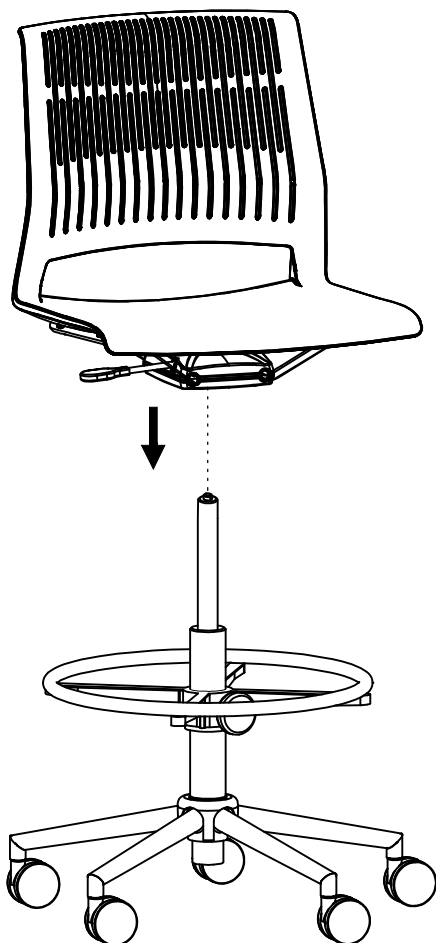

Done !

Function:

1. Adjust Seat Height

Upward: get your body off the seat and pull the lever to lift the seat to an appropriate height.

Downward: press down and pull the lever to lower the seat to the appropriate height.

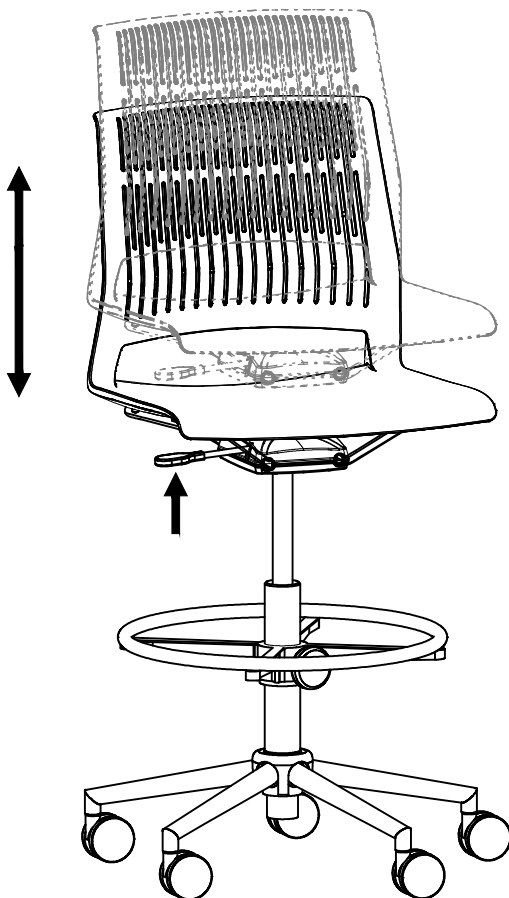

Function:

2. Foot rest height adjustment

Turn the adjustment knob C counterclockwise to loose the foot rest and adjust it to the right position. Then turn the adjustment knob C clockwise to fix the foot rest.

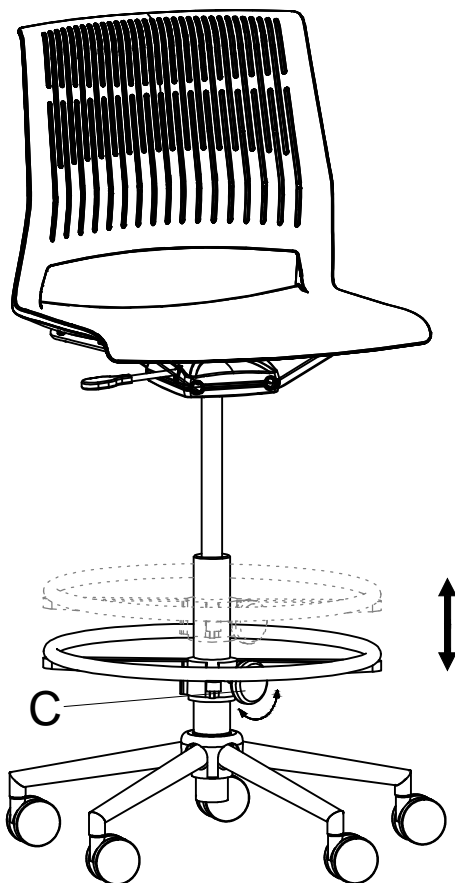

Acceptance note:

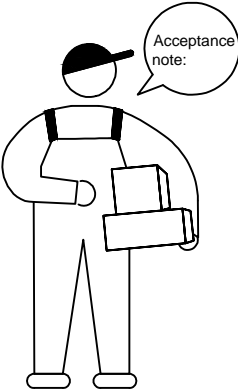

● Clean the surface.

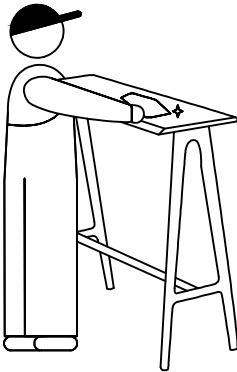

● Tidy up.



● Check and deliver.

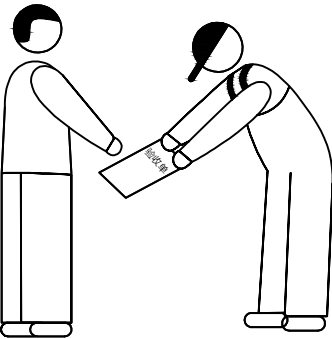



 Suite 150, Building 525 Technology Drive, Irvine, CA.92618

 sunonglobal.com

 949-337-8838

 info.us@isunon.com

