

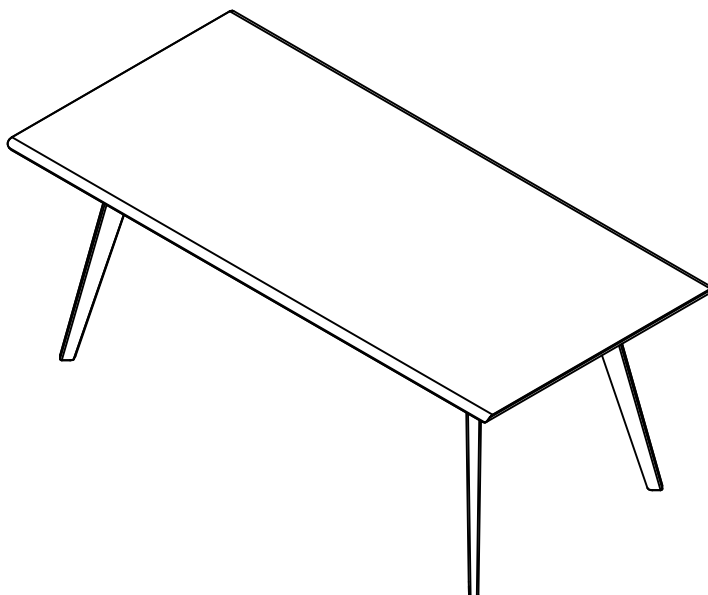

# Jason Series EW80 Executive Table Installation Manual



This manual is used for the installation of EW80.200095.  
Please read this manual carefully before use and keep it properly.

## Assembly note:

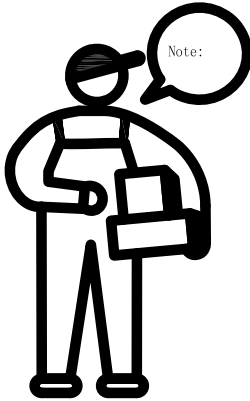

● Use a protective layer and handle the product with care.

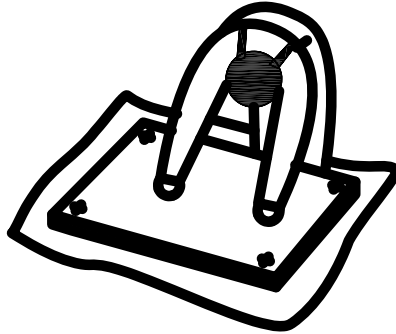

● At least two people are required.

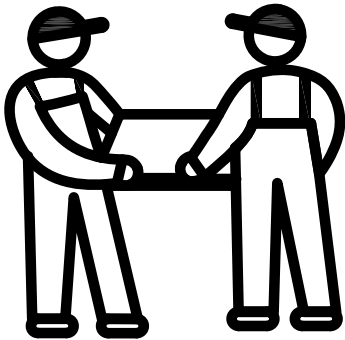

● Contact Sunon if you have any confusions.

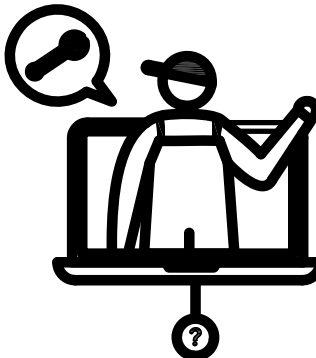

---

This picture shows all the accessories required, among them some are key accessories.  
If you have missed any, please contact Sunon. Tel:+86-400-8600-666

---

Explosion diagram:

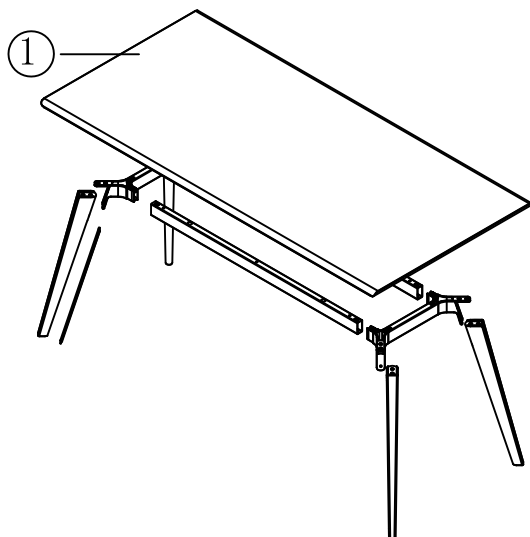

No	Name	Pcs
1	tabletop	1

Accessory list:

Allen key	4#	1	Allen key	5#	1	round-head hex screw	M6x15	6
adjuster	M6x18	4	table leg	768*76*48	3	leg ( cabling )	768*76*48	1
leg connector	abnormal shape	2	steel beam	1235*60*30	2			

---

1. Install adjusters.

---

1

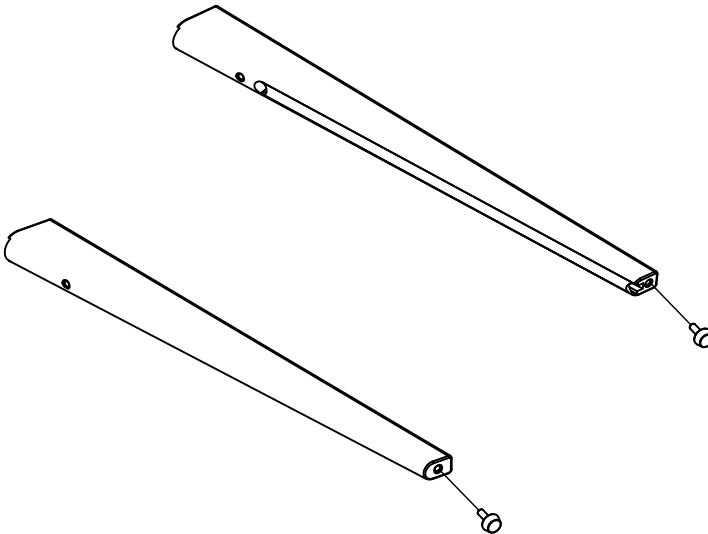

● M6\*18  
(x4)



● 768\*76\*48  
(x3)

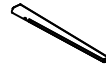

● 768\*76\*48  
(x1)

- 
1. Install leg connectors ( the accessory comes with 12 M6\*25 screws )
  2. Don't tighten the screws until finishing the installation of all screws.
- 

# 2

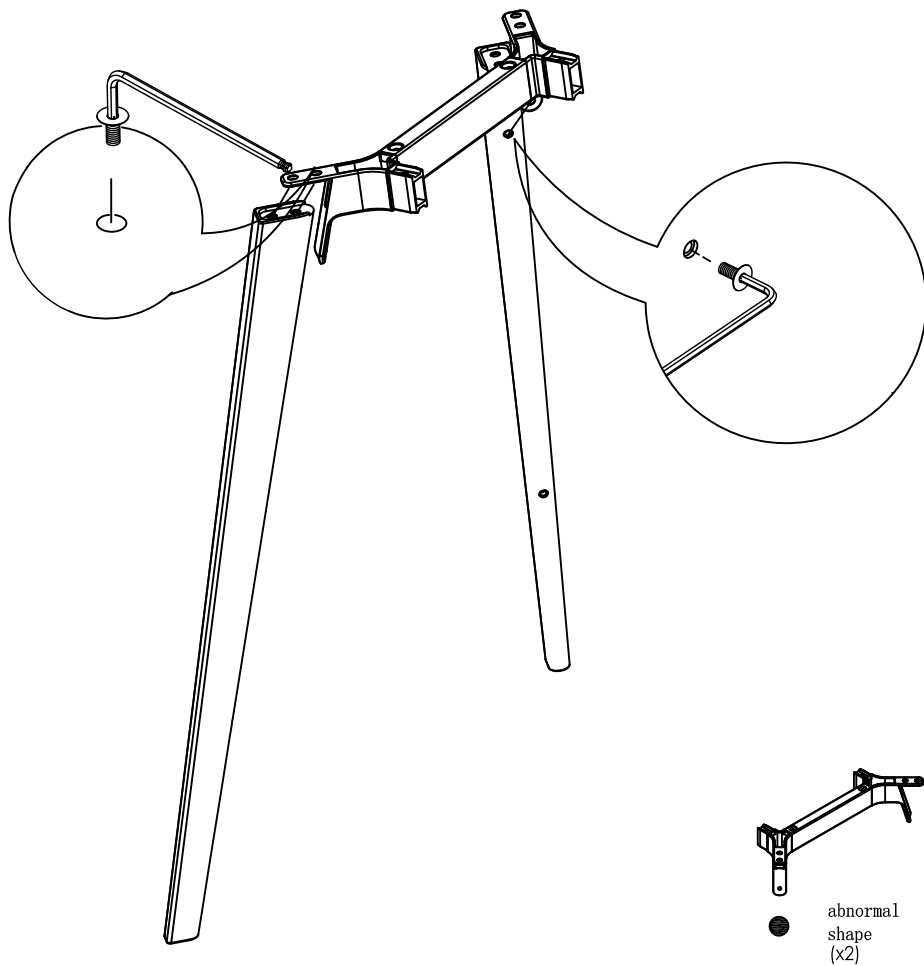

---

1. Remove the pre-installed 8 M8\*16 screws inside the leg connectors.

---

**3**

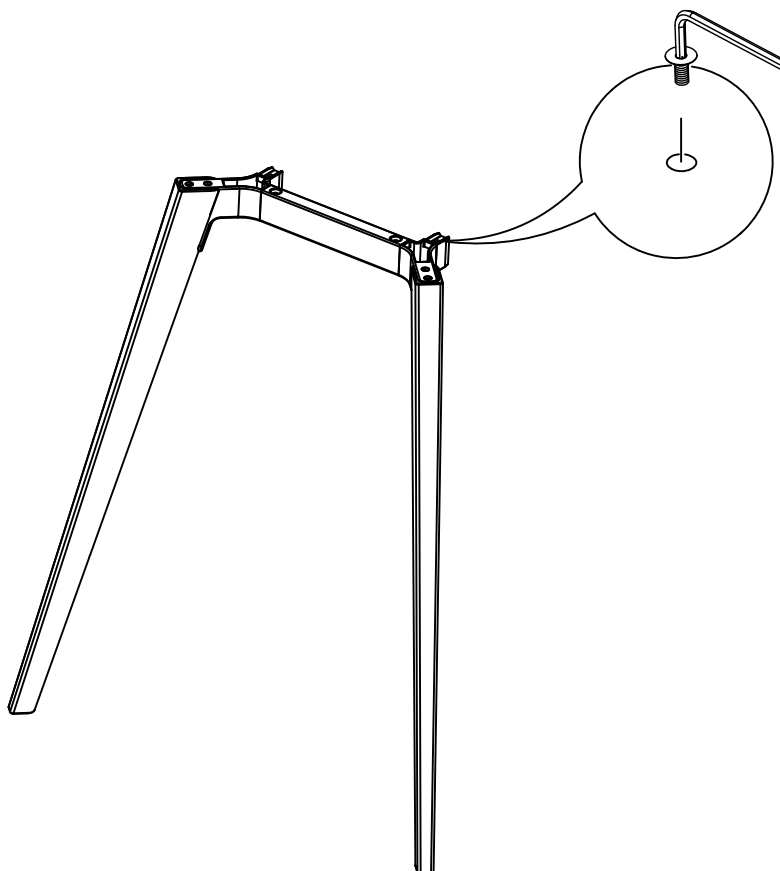

- 
1. Use the pre-installed M8\*16 screws of leg connectors to install steel beams.
  2. If there is modesty panel, install the outside hangers.
- 

# 4

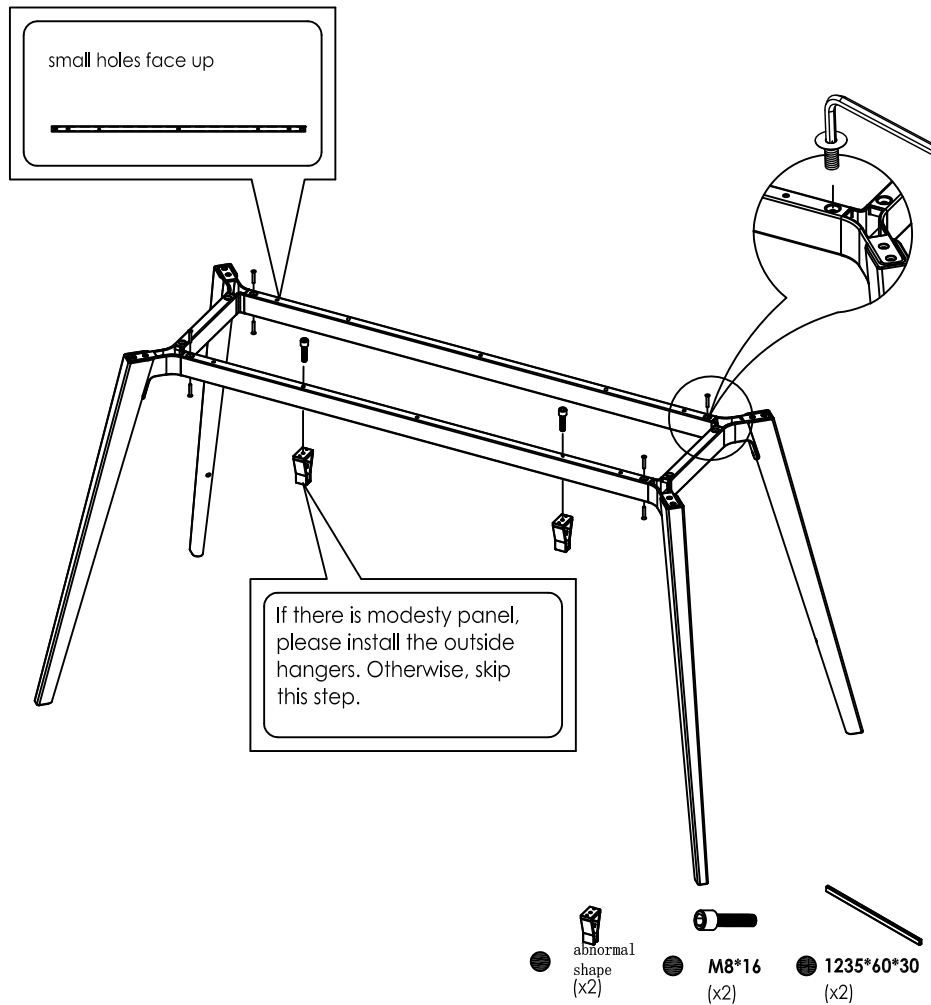



---

1.Install the tabletop. ( Turn the table upside down and put it on a piece of cardboard.)

---

# 5

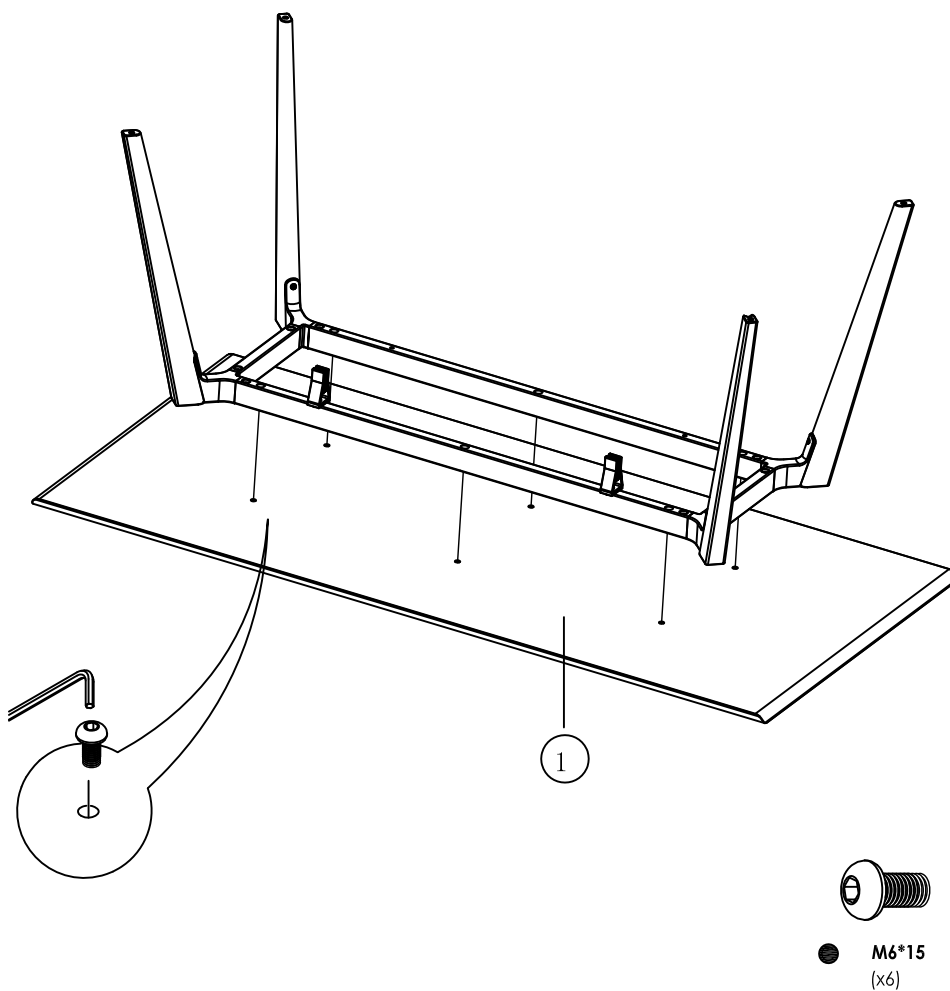

---

1. Install the inside hangers on the modesty panels.

---

6

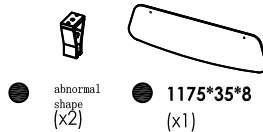
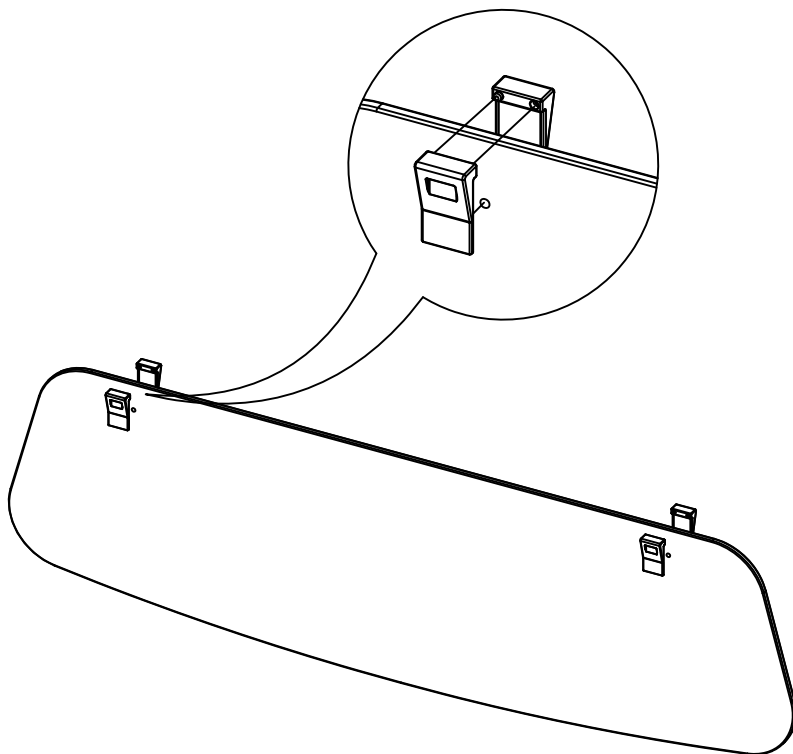

---

1. Push the modesty panel inwards to make the inside hangers hang on the outside hangers.

---

7

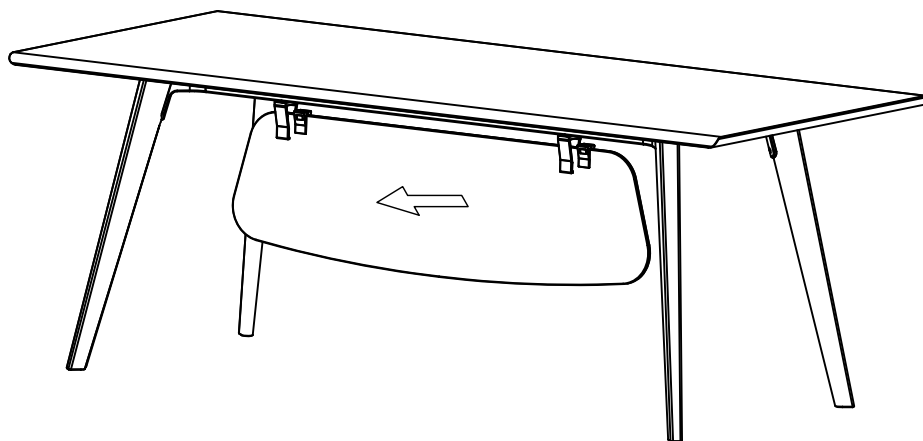

---

1.Cabling.

---

8

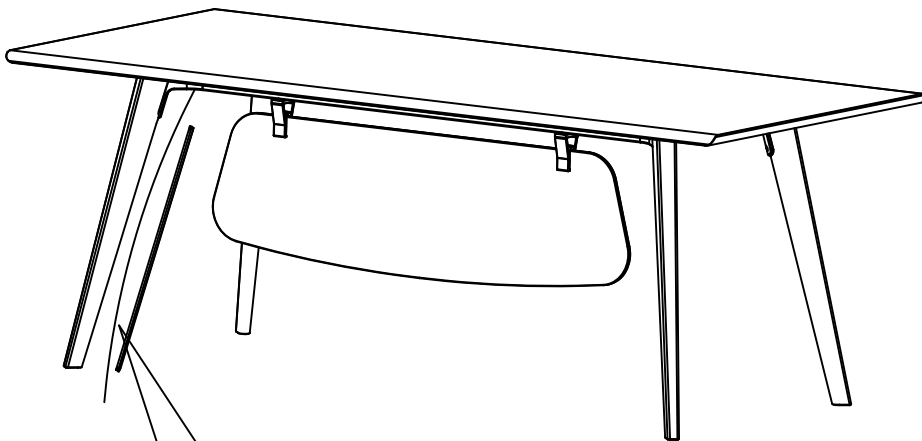

### Cabling

Remove the covering plate  
and manage the wiring.  
Then restore the plate.

Done !

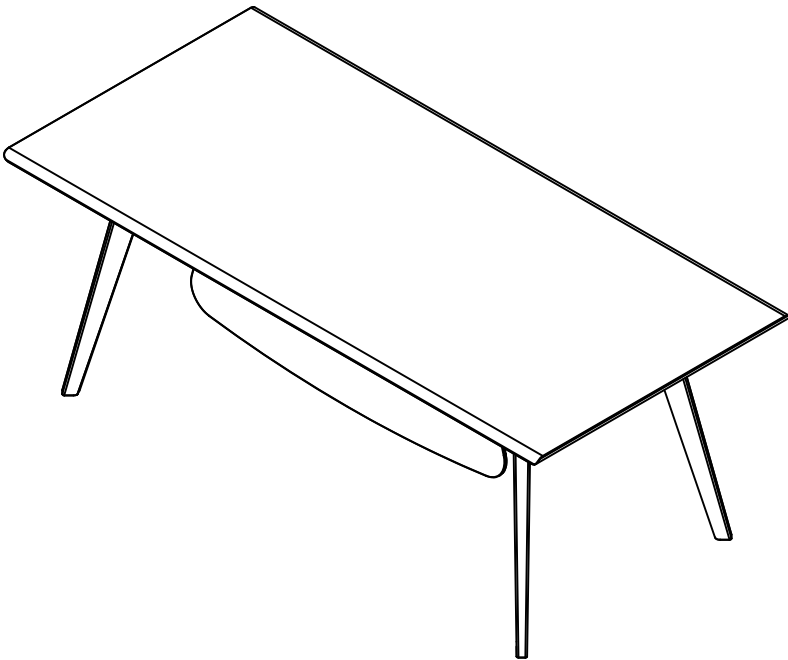

Acceptance note:

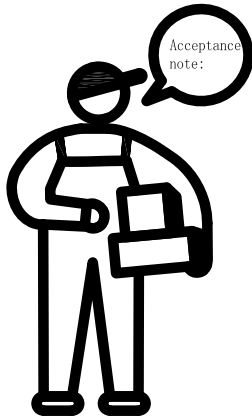

● Clean the surface.



● Tidy up the scene.



● Check and accept.

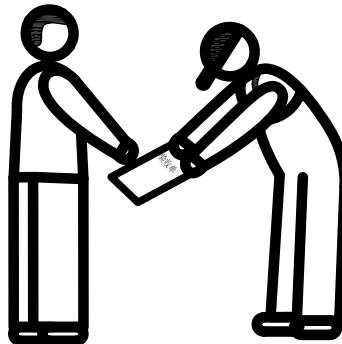



Suite 150, Building 525 Technology Drive, Irvine, CA.92618  
sunonglobal.com      949-337-8838      info.us@isunon.com

